

# SURFACE NAVY 2009 HYATT REGENCY CRYSTAL CITY ARLINGTON, VIRGINIA

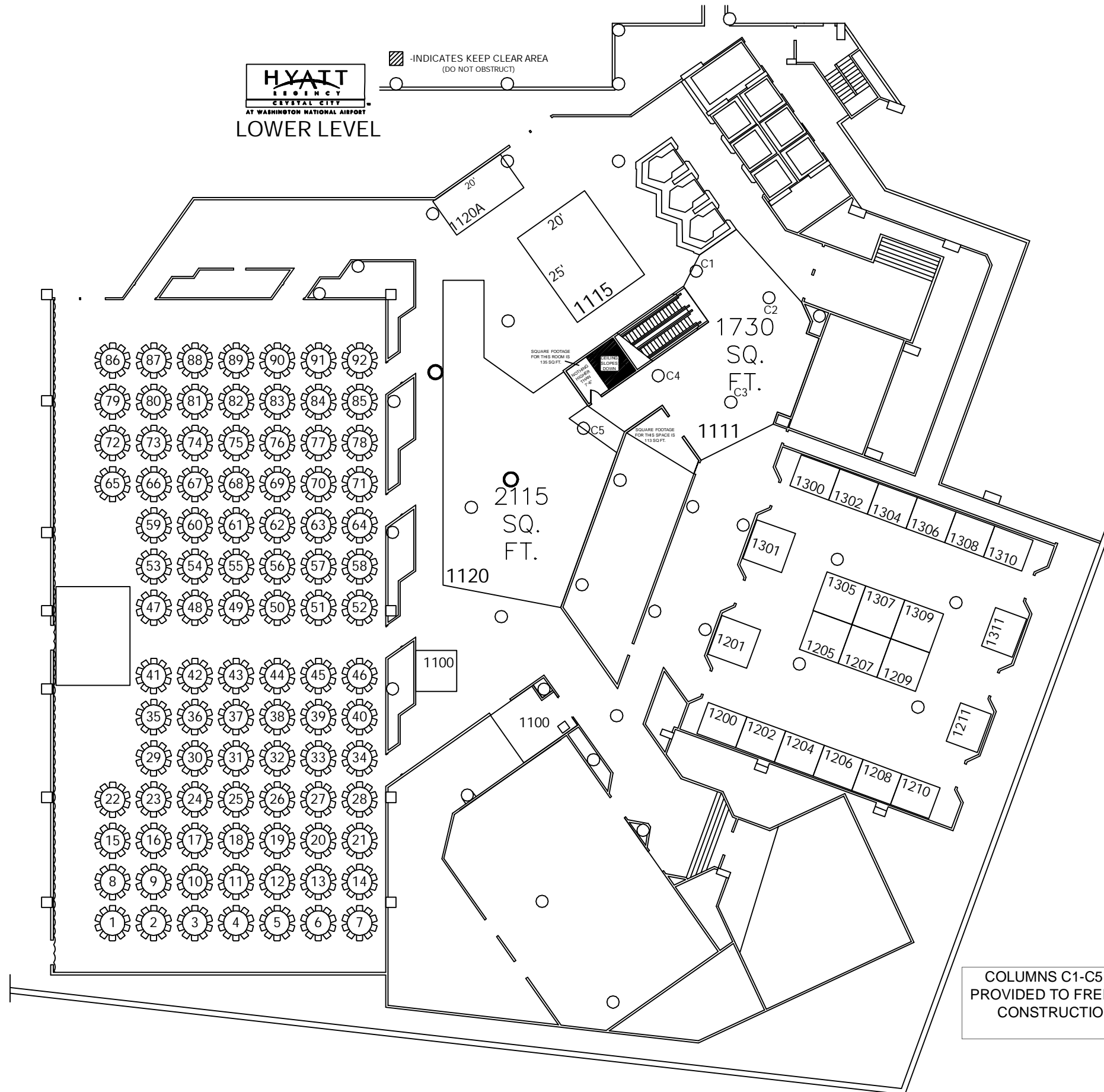

-INDICATES KEEP CLEAR AREA  
(DO NOT OBSTRUCT)



COLUMNS C1-C5 ARE 36" ROUND OR 117" CIRCUMFERENCE. COLUMN MEASUREMENTS PROVIDED TO FREEMAN'S BEST ACCURATE MEASUREMENT AS OF 06/02/2008. ANY BOOTH CONSTRUCTION IS AT THE RESPONSIBILITY OF LOCKHEED MARTIN AND ANY THIRD PARTIES HIRED TO REPRESENT THEM.